

Verbindungsrippel

Pièce folle

Tube stub

SO 51300

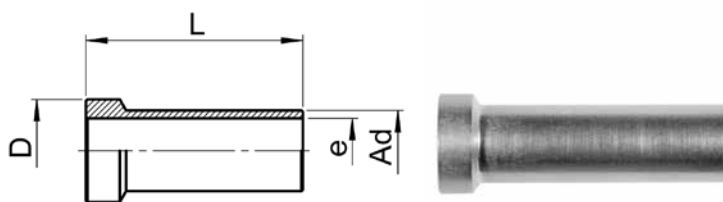

Type -Ad	Mat.-Nr.	bar	L	D	e	kg/100
SO 51300-A6	056.1300.060	200	21.0	8.9	3.8	0.410
SO 51300-A8	056.1300.080	200	24.0	10.9	5.6	0.670
SO 51300-A10	056.1300.100	160	26.0	12.9	6.5	1.200
SO 51300-A12	056.1300.120	160	31.0	14.9	8.0	1.800
SO 51300-A15	056.1300.150	100	35.0	18.4	11.0	2.700
SO 51300-A18	056.1300.180	100	39.0	22.6	14.0	4.000
SO 51300-A22	056.1300.220	64	43.0	26.4	19.0	4.400

Verbindungsrippel reduziert

Pièce folle réduite

Tube stub reduced

SO 51300 RED

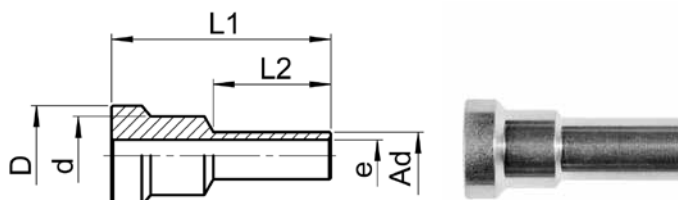

Type -d-Ad	Mat.-Nr.	bar	L1	L2	D	e	kg/100
SO 51300-8-A6	056.1304.140	200	26.0	14.0	10.9	3.8	0.740
SO 51300-10-A6	056.1304.175	200	28.0	14.0	12.9	3.8	1.100
SO 51300-10-A8	056.1304.190	200	28.0	14.0	12.9	5.6	1.100
SO 51300-12-A6	056.1304.215	200	29.0	13.0	14.9	3.8	1.700
SO 51300-12-A8	056.1304.225	200	29.0	13.5	14.9	5.6	1.600
SO 51300-12-A10	056.1304.240	160	31.0	16.0	14.9	6.5	1.800
SO 51300-15-A10	056.1304.410	160	35.0	17.0	18.4	6.5	3.100
SO 51300-15-A12	056.1304.420	160	35.0	17.5	18.4	8.0	3.100
SO 51300-18(16)-A12	056.1304.480	160	35.0	16.5	22.4	8.0	4.200
SO 51300-18(16)-A16	056.1304.620	100	41.0	31.5	22.4	12.0	4.100
SO 51300-22-A18	056.1304.755	64	47.0	26.0	26.4	14.0	6.900
SO 51300-28-A22	056.1304.900	40	55.0	31.0	33.9	19.0	10.800

Fortsetzung nächste Seite

Suite à la prochaine page

Continued on next page