

6501 Stud Fitting, Male BSPP Thread

POM, EPDM



ØD	C		E	F	G	H	Kg
6	G1/8	6501 06 10WP2	6	15	18	18	0.003
	G1/4	6501 06 13WP2	8.5	18	18	15.5	0.004
	G1/8	6501 08 10WP2	6	17	18	18.5	0.005
8	G1/4	6501 08 13WP2	8.5	18	18	20	0.006
	G3/8	6501 08 17WP2	6	21	20	17.5	0.007
	G1/4	6501 10 13WP2	8.5	19	20	22	0.007
10	G3/8	6501 10 17WP2	9	21	20	17	0.007
	G1/2	6501 10 21WP2	12.5	26	21.5	17	0.011
	G3/8	6501 12 17WP2	9	24	21.5	25	0.011
12	G1/2	6501 12 21WP2	12.5	26	21.5	20	0.012

Collet technology
NSF certified fitting only

6505 Stud Fitting, Male BSPT Thread

Bio-based polymer, EPDM

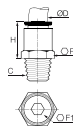

ØD	C		F	F1	H	Kg
4	R1/8	6505 04 10WP2	11	3	18	0.003
	R1/4	6505 04 13WP2	14	3	18	0.004
6	R1/8	6505 06 10WP2	11	4	18	0.002
	R1/4	6505 06 13WP2	14	4	18	0.004
8	R1/8	6505 08 10WP2	17	6	20	0.004
	R1/4	6505 08 13WP2	14	6	20	0.004
	R3/8	6505 08 17WP2	17	6	20	0.005
10	R1/4	6505 10 13WP2	17	7	21.5	0.005
	R3/8	6505 10 17WP2	19	7	21.5	0.007
	R1/2	6505 10 21WP2	22	7	21.5	0.010
12	R3/8	6505 12 17WP2	19	9	24.5	0.008
	R1/2	6505 12 21WP2	22	9	24.5	0.012

6505 Stud Fitting, Male NPTF Thread

Inch

Bio-based polymer, EPDM

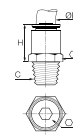

ØD	C		F	F1	H	Kg
1/4	NPT1/8	6505 56 11WP2	1/2	5/32	17	0.002
	NPT1/4	6505 56 14WP2	9/16	5/32	17	0.003
3/8	NPT1/4	6505 60 14WP2	3/4	1/4	22	0.006
	NPT3/8	6505 60 18WP2	3/4	1/4	22	0.007
1/2	NPT3/8	6505 62 18WP2	15/16	3/8	28	0.012
	NPT1/2	6505 62 22WP2	15/16	3/8	28	0.013

Thread without pre-coating

6505 Stud Fitting, Male BSPT Thread

Inch

Bio-based polymer, EPDM

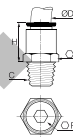

ØD	C		F	F1	H	Kg
1/4	R1/8	6505 56 10WP2	11	5	17	0.002
	R1/4	6505 56 13WP2	14	5	17	0.003
3/8	R3/8	6505 60 17WP2	19	7	22	0.006
	R1/2	6505 60 21WP2	22	7	28	0.012
1/2	R1/2	6505 62 21WP2	24	9	28	0.017

5/32" (4mm) and 5/16" (8mm) are available
Thread without pre-coating

6315 Stud Connector, Female BSPT Thread

Bio-based polymer, EPDM

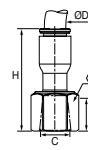

ØD	C		E	F	H	Kg
6	R1/8	6315 06 10WP2	11	13	32	0.003
	R1/4	6315 06 13WP2	14	16	33	0.004
8	R1/4	6315 08 13WP2	14	16	33.5	0.004
	R3/8	6315 08 17WP2	14	20	36	0.009

WP3 = high volumes (number of parts per bag: 40, 50 or 100, depending on the diameters).

6315 Stud Fitting, Female NPTF Thread

Inch

Bio-based polymer, EPDM

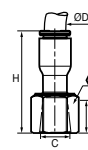

ØD	C		F	H	Kg
1/4	NPT1/4	6315 56 14WP2	11/16	30	0.003
3/8	NPT3/8	6315 60 18WP2	13/16	36	0.007

6352 Stud Fitting Flat Type, Female BSPP Thread Inch

Bio-based polymer, EPDM

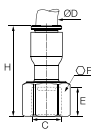

ØD	C		E	F	H	Kg
3/8	G3/8	6352 60 17WP2	12	22	36	0.008
	G1/2	6352 60 21WP2	12	27	36	0.011

6325 Faucet Connector, Female UNS Thread Inch

Bio-based polymer, EPDM

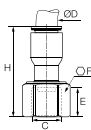

ØD	C		E	F	H	Kg
1/4	UNS7/16-24	6325 56 133WP2	7	9/16	31	0.002

6521 Stud Standpipe, Male BSPT Thread

Bio-based polymer

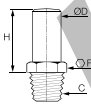

ØD	C		F	H	Kg
6	R1/8	6521 06 10WP2	13	19	0.002
	R1/4	6521 06 13WP2	14	19	0.003
	R3/8	6521 06 17WP2	17	19	0.004
8	R1/8	6521 08 10WP2	19	23	0.003
	R1/4	6521 08 13WP2	19	23	0.004
	R3/8	6521 08 17WP2	19	23	0.004
10	R1/4	6521 10 13WP2	19	25	0.004
	R3/8	6521 10 17WP2	19	25	0.005
	R1/2	6521 10 21WP2	22	25	0.008
12	R3/8	6521 12 17WP2	22	28	0.005
	R1/2	6521 12 21WP2	22	28	0.007

Thread without pre-coating.

6521 Stud Standpipe, Male NPTF Thread Inch

Bio-based polymer

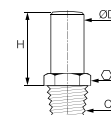

ØD	C		F	H	Kg
3/8	NPT1/4	6521 60 14WP2	3/4	25	0.004
	NPT3/8	6521 60 18WP2	3/4	25	0.004

Thread without pre-coating.

6521 Stud Standpipe, Male BSPT Thread Inch

Bio-based polymer

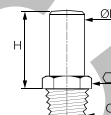

ØD	C		F	H	Kg
1/4	R1/8	6521 56 10WP2	14	19	0.002
	R1/4	6521 56 13WP2	14	19	0.002
	R3/8	6521 56 17WP2	17	19	0.004
3/8	R3/8	6521 60 17WP2	19	25	0.004

Thread without pre-coating.
5/16" (8mm) also available.

6300 LIQUIfit® Cartridge

Brass, EPDM

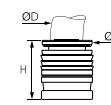

ØD		G	G1	H	L	Kg
4	6300 04 00	8	11	10	554	0.002
6	6300 06 00	10	14.5	11.5	629	0.002
8	6300 08 00	13	15	15	794	0.003
10	6300 10 00	15.5	19.5	17	930	0.005
12	6300 12 00	18.5	21	19.5	1038	0.010

50 cartridges per Carstick®

Please consult us for detailed drawings of cavity dimensions and tolerances

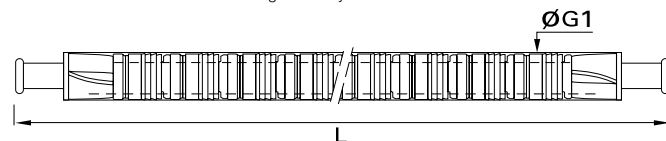

Sealing Profile for Female Thread Stud Fitting

Stud Fitting,
Female NPTF Thread
6315

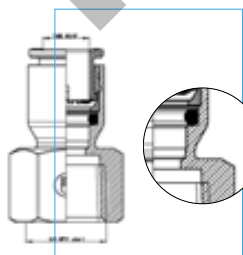

Stud Fitting Flat Type,
Female BSPP Thread,
6352

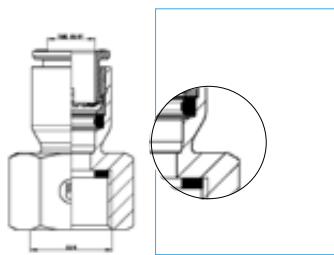

6300 Carstick+ Cartridge EPDM



ØD		G	G1	H	L	kg
4	6300 04 01 24	8.1	10.3	10.4	520	0.001
6	6300 06 01 24	9.9	15.3	11.8	590	0.002

6300 Carstick+ Cartridge FKM



ØD		G	G1	H	L	kg
4	6300 04 01 26	8.1	10.3	10.4	520	0.001
6	6300 06 01 26	9.9	15.3	11.8	590	0.002

6300 LIQUIfit® Cartridge

Inch

Brass, EPDM

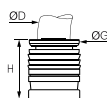

ØD		G	G1	H	L	Kg
1/4	6300 56 00	10.5	14.5	12.5	600	0.002
3/8	6300 60 00	15.5	19	17	930	0.005
1/2	6300 62 00	22	25	23	1038	0.011

50 cartridges per Carstick®
5/32" (4 mm) and 5/16" (8 mm) also available.
Please consult us for detailed drawings of cavity dimensions and tolerances

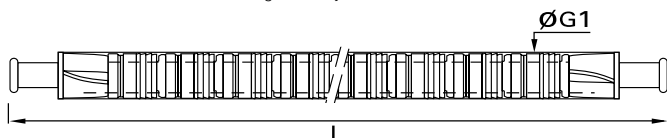

6579 Fixed Elbow, Male BSPT Thread

Bio-based polymer, EPDM

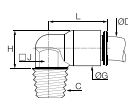

ØD	C		G	H	J	L	Kg
	R1/8	6579 06 10WP2	11	14	10	19	0.002
6	R1/4	6579 06 13WP2	11	14	10	19	0.003
	R3/8	6579 06 17WP2	11	14	10	19	0.004

Thread without pre-coating.

6579 Fixed Elbow, Male NPTF Thread

Inch

Bio-based polymer, EPDM

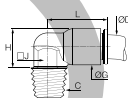

ØD	C		G	H	J	L	Kg
	NPT1/8	6579 56 11WP2	11	22	38	18	0.009
1/4	NPT1/4	6579 56 14WP2	11	26	38	18	0.003
3/8	NPT1/4	6579 60 14WP2	16	32	12	26	0.006

Thread without pre-coating.

6579 Fixed Elbow, Male BSPT Thread

Inch

Bio-based polymer, EPDM

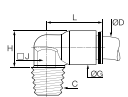

ØD	C		G	H	J	L	Kg
1/4	R1/4	6579 56 13WP2	11	26	10	18	0.003
3/8	R3/8	6579 60 17WP2	16	32	13	26	0.006

Thread without pre-coating.

6599 Stud Elbow, Male BSPP Thread

POM, EPDM



ØD	C		E	F	G	H	Kg
	G1/8	6599 06 10WP2	6	17	15	24.5	0.007
6	G1/4	6599 06 13WP2	8.5	18	15	33	0.008
	G1/8	6599 08 10WP2	6	18	17.5	26	0.010
8	G1/4	6599 08 13WP2	8.5	18	17.5	26	0.011
	G3/8	6599 08 17WP2	9	22	17.5	26	0.012
	G1/4	6599 10 13WP2	8.5	22	20	29.5	0.015
10	G3/8	6599 10 17WP2	9	22	20	29.5	0.015
	G1/2	6599 10 21WP2	12.5	26	20	29.5	0.019
	G3/8	6599 12 17WP2	9	26	23	34.5	0.023
12	G1/2	6599 12 21WP2	12.5	26	23	34.5	0.025

Collet technology
Thread without pre-coating; the body swivels for positioning purposes.
NSF certified fitting only

6509 Stud Elbow, Male BSPT Thread

Bio-based polymer, EPDM

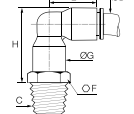

ØD	C		F	G	H	L	Kg
	R1/8	6509 06 10WP2	13	10.5	28	24	0.037
6	R1/4	6509 06 13WP2	14	10.5	28	24	0.007
	R3/8	6509 06 17WP2	17	10.5	28	24	0.008
	R1/8	6509 08 10WP2	19	13.5	34	29.5	0.010
8	R1/4	6509 08 13WP2	19	13.5	34	29.5	0.011
	R3/8	6509 08 17WP2	19	13.5	34	29.5	0.011
	R1/4	6509 10 13WP2	19	16	38	34.5	0.019
10	R3/8	6509 10 17WP2	19	16	38	34.5	0.020
	R1/2	6509 10 21WP2	22	16	38	34.5	0.023
	R3/8	6509 12 17WP2	22	19	44	40	0.022
12	R1/2	6509 12 21WP2	22	19	44	40	0.024

Thread without pre-coating; the body swivels for positioning purposes.

6509 Stud Elbow, Male NPTF Thread

Inch

Bio-based polymer, EPDM

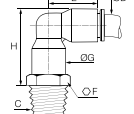

ØD	C		F	G	H	L	Kg
	NPT1/8	6509 56 11WP2	1/2	11	28	23.5	0.003
1/4	NPT1/4	6509 56 14WP2	9/16	11	28	23.5	0.004
	NPT3/8	6509 56 18WP2	3/4	11	28.5	23.5	0.006

Thread without pre-coating, the body swivels for positioning purposes.

6509 Stud Elbow, Male BSPT Thread

Inch

Bio-based polymer, EPDM

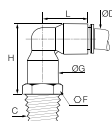

ØD	C		F	G	H	L	Kg
1/2	R1/2	6509 62 21WP2	24	22	50.5	46.5	0.027

5/16" (8 mm) also available.

Thread without pre-coating, the body swivels for positioning purposes.

6508 Branch Tee, Male BSPT Thread

Bio-based polymer, EPDM

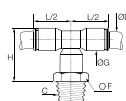

ØD	C		F	G	H	L/2	Kg
6	R1/8	6508 06 10WP2	13	10.5	28	18	0.008
	R1/4	6508 06 13WP2	14	10.5	28	18	0.009
	R3/8	6508 06 17WP2	17	10.5	28	18	0.010
8	R1/8	6508 08 10WP2	19	13.5	34	23	0.012
	R1/4	6508 08 13WP2	19	13.5	34	23	0.013
	R3/8	6508 08 17WP2	19	13.5	34	23	0.013
10	R1/4	6508 10 13WP2	19	16	38	26.5	0.018
	R3/8	6508 10 17WP2	19	16	38	26.5	0.019
	R1/2	6508 10 21WP2	22	16	38	26.5	0.022
12	R1/2	6508 12 21WP2	22	19	44	31	0.026

Thread without pre-coating, the body swivels for positioning purposes.

6503 Run Tee, Male BSPT Thread

Bio-based polymer, EPDM

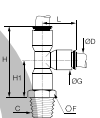

ØD	C		F	G	H	H1	L	Kg
6	R1/4	6503 06 13WP2	14	10.5	40	22	18.5	0.009
	R1/8	6503 08 10WP2	19	13.5	50	27	23	0.012
8	R1/4	6503 08 13WP2	19	13.5	50	27	23	0.013
	R3/8	6503 08 17WP2	19	13.5	50	27	23	0.013
12	R3/8	6503 12 17WP2	22	19	65.5	34.5	31	0.024
	R1/2	6503 12 21WP2	22	19	65.5	34.5	31	0.026

Thread without pre-coating, the body swivels for positioning purposes.

6355 Unequal Connector, Female BSPP Thread

Bio-based polymer, EPDM

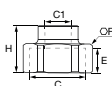

C	C1		E	F	H	Kg
G3/4	G1/4	6355 13 27WP2	10	32	23.5	0.050